

$\phi \frac{.102}{2.6}$ (+.004 / -.003) (4 PLCS)

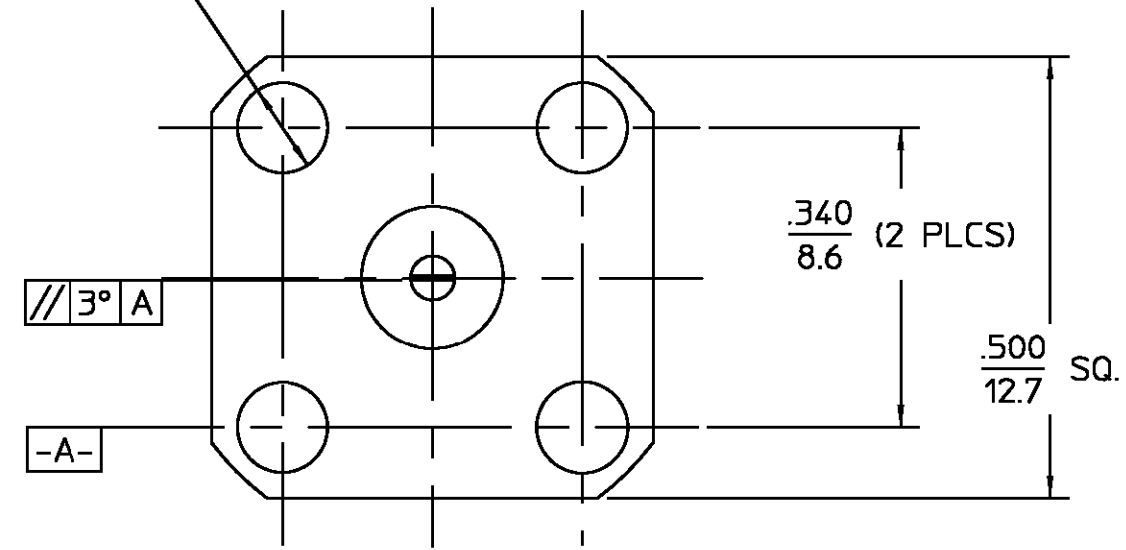

REVISIONS			
REV	DESCRIPTION	DATE	APPROVED
01 ₁	REVISED	10/17/86	[Signature]

ELECTRICAL	MECHANICAL	ENVIRONMENTAL
Nominal Impedance (Ohms) <u>50 ±1</u>	Interface Dimensions MIL-STD-348A, Fig. 310-1	Temperature Rating <u>-55°C TO +125°C</u>
Frequency Range (GHz) <u>DC to 18</u>	Recommended Mating Torque <u>7-10 IN-LBS</u>	Vibration MIL-STD-202, Method 204, Condition D.
Volt Rating (VRMS MAX) @ Sea Level <u>335</u>	Mating Characteristics: Insertion (MAX Lbs) <u>N/A</u>	Shock MIL-STD-202, Method 213, Condition B.
VSWR <u>1.05 ±.005 f(GHz)</u>	Withdrawal (MIN Oz) <u>N/A</u>	Thermal Shock MIL-STD-202, Method 107, Condition B.
Insertion Loss (dB MAX) <u>0.06 √f(GHz)</u>	Force to Engage and Disengage (In-Lbs MAX) <u>2.0</u>	Moisture Resistance MIL-STD-202, Method 106, Except Vibration Shall Be Omitted.
RF Leakage (dB MIN) <u>-70 f(GHz)</u>	Center Contact Captivation Axial (Lbs) <u>6.0</u>	Corrosion - MIL-STD-202, Method 101, Condition B, 5% salt spray
Corona, 70,000 Ft (VRMS MIN) <u>250</u>	Cable Retention Axial Force (Lbs) <u>N/A</u>	
Dielectric Withstanding Voltage (VRMS MIN) @ Sea Level <u>1,000</u>	Torque (In-Oz) <u>N/A</u>	
Contact Resistance (Milliohms MAX) Center Contact <u>3.0</u>	Weight (Grams) <u>TBD</u>	
Outer Contact <u>2.0</u>		
Cable to Housing <u>N/A</u>		
RF High Potential @ Sea Level (VRMS MIN @ 5 MHz) <u>670</u>		
IR.(Megohms MIN) <u>5,000</u>		

HOUSING COUPLING NUT	STAINLESS STEEL PER ASTM-A484 AND ASTM-A582, TYPE 303	PASSIVATE PER QQ-P-35
DIELECTRIC	TFE FLUOROCARBON PER ASTM-D-1457	N/A
CENTER CONTACT	BERYLLIUM COPPER PER ASTM-B-196 OR ASTM-B-197, ALLOY C17300, CONDITION H	GOLD PLATE PER MIL-G-45204
RETAINING RING	BERYLLIUM COPPER PER ASTM-B-194, ALLOY C17200, CONDITION H	N/A
GASKET	SILICONE RUBBER PER ZZ-R-765	N/A

COMPONENT	MATERIAL	FINISH
UNLESS OTHERWISE SPECIFIED DIMENSIONS ARE IN INCHES	DRAWN BY <u>JB</u> DATE <u>7/28/87</u>	
FRAC. ± 1/64	CHECKED BY <u>MH/M</u> DATE <u>8/6/87</u>	AMP Incorporated 140 Fourth Avenue Waltham, MA 02451-7599
DEC. ±.005	APPD BY <u>BAR</u> DATE <u>8/6/87</u>	
ANGLES ± 1°	TITLE <u>OSM STRAIGHT PANEL PLUG 4 HOLE FLANGE MOUNT RECEPTACLE TAB TERMINAL</u>	
These drawings and specifications are the property of M/A COM Interconnect Div. and shall not be reproduced or copied or used in whole or in part as the basis for the manufacture or sale of a item(s) without written permission.	USE ASSY PROCEDURE	NO. A.P. <u>N/A</u>
	SIZE <u>B</u>	CODE IDENT NO. <u>2051-5339-02</u>
	SCALE <u>5:1</u>	REV <u>01₁</u>
		SHEET 1 OF 1

CUSTOMER DRAWING

AMP PART # 1060124-1
SHEET 1 OF 1 REV A